

G23A Series

Motor electronic lock for DC charging gun



■ Features

- High-density sealed motor electronic lock , meeting IP67 requirements
- Reliable locking,manual and automatic unlocking
- Accurate locking or unlocking positioning and clear gear
- The motor electronic lock is sensitive to forward and reverse conversion,with long service life and stable and reliable.

■ Application

- ◆ Charging gun

■ Parameters

Rating		12VDC.
Insulation Resistance		100MΩ Min.
Dielectric Strength		500VAC (50~60Hz)
Degree of Protection		IEC IP67 (Drive roller and housing excluded)
Work Temperature		-40°C ~ +85°C
Work Humidity		45%RH~85%RH
Service Life	Electrical	60,000 cycles
	Mechanical	60,000 cycles (Min.)
Operating Frequency	Electrical	20 cycles/min
	Mechanical	20 cycles/min
Operating Features (At 12VDC)	(OF)	700g.cm (Min.)
	(HF)	250g.cm (Min.)
	(PT)	45°±5°
	Shaft Strength	200N (No mechanical damage under vertical axial force)
	(OF)	250g.cm (Min.)

G23A Series Motor DC Electronic Lock Ordering Model Guide

G23A	250	A	01	A	300	A	A	A	T001
G23A Electronic Lock Series	Torque 25 250g.cm 0 (Min.)	Wire Spec A 26# AWG B 24# AWG C 22# AWG D 20# AWG ... Other	Feedback Switch Function A (NC) B (NO) ... Other	Manual Unlocking Type A None 01 "—" type base unlock 02 "+" type base unlock	Wire Type A AVSS B UI1007 C UI1061 D UI1332 E UI1430 F UI1571 G FLY-A H UI3266	Wire Length OO None 300 300mm Wire Length Motor Positive Red Wire Negative Black Wire COM Terminal White Wire NC Orange Wire 500 500mm Wire Length Motor Positive Red Wire Negative Black Wire COM Terminal White Wire NC Orange Wire	Conductor Holder Type N None A A type base with wires B B type base with wires	Resistance combination N None A Switch Built-in Resistor Resistance Combination R1=1KΩ; R2=1KΩ B Switch Built-in Resistor Resistance Combination R1=2.2KΩ; R2=3.3KΩ C Switch Built-in Resistor Resistance Combination R1=1.5KΩ; R2=1.8KΩ D Switch Built-in Resistor Resistance Combination R1=2.0KΩ; R2=2.7KΩ E Switch Built-in Resistor Resistance Combination R1=2.0KΩ; R2=1.5KΩ F Switch Built-in Resistor Resistance Combination R1=100Ω; R2=3.3KΩ G Switch Built-in Resistor Resistance Combination R1=1.0KΩ; R2=3.3KΩ H Switch Built-in Resistor Resistance Combination R1=1.50KΩ; R2=3.30KΩ J Switch Built-in Resistor Resistance Combination R1=90KΩ; R2=2.7KΩ	Custom Code General TO 01 ... Other
	...	Other

Basic overall dimensions and installation dimensions

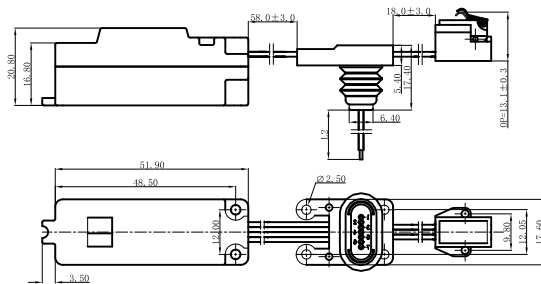
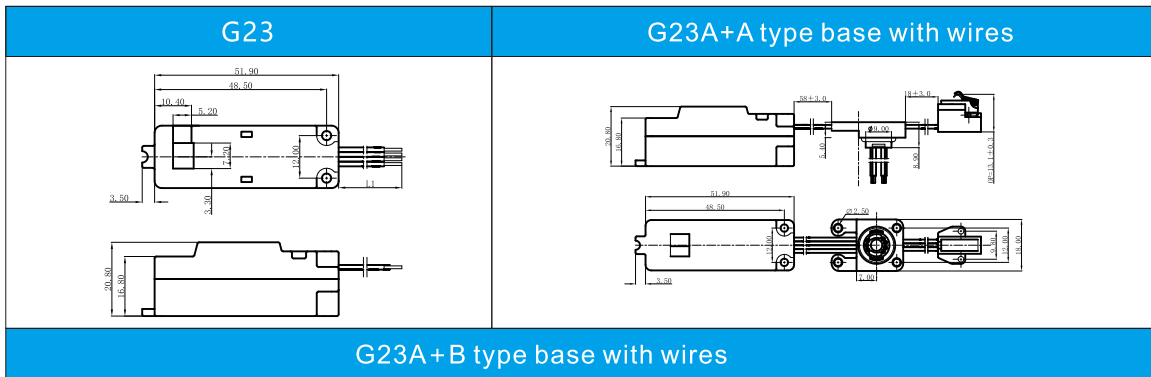

Base with wires type

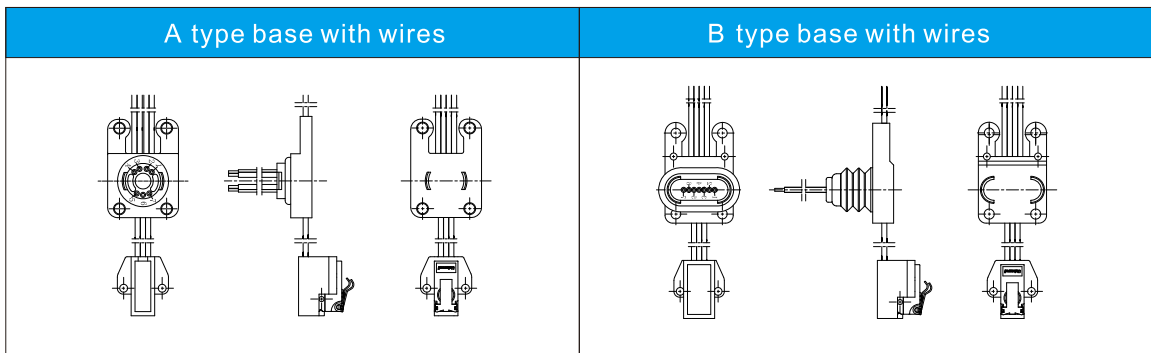

Manual unlocking port type

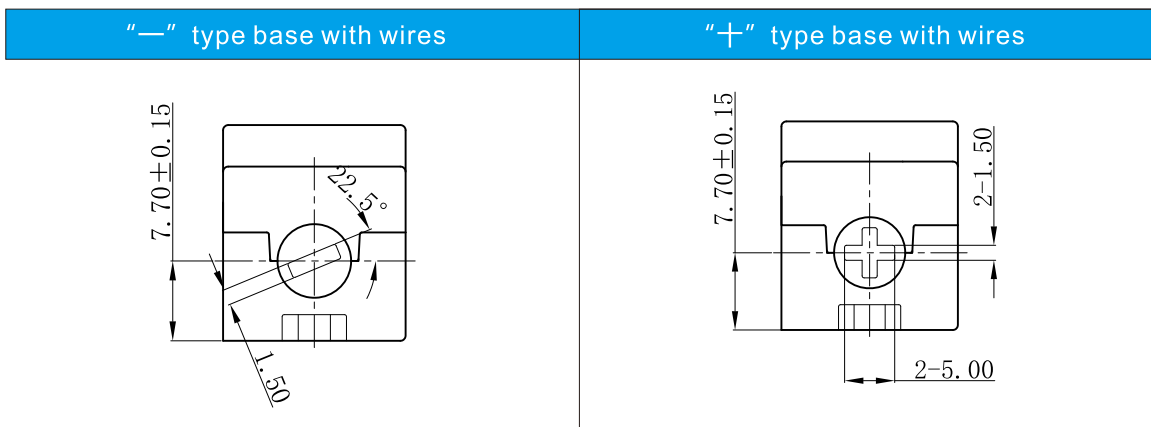

Feedback switch function

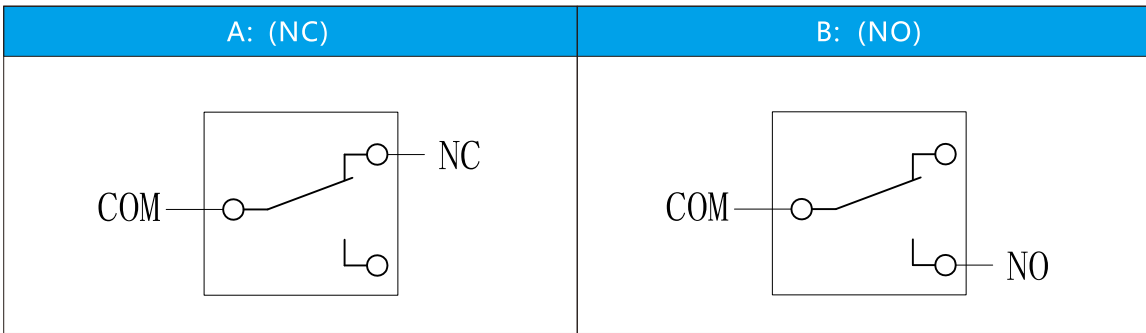

Dimensions and Operating Characteristics

◆ G23A-250BB02AXXXNNU

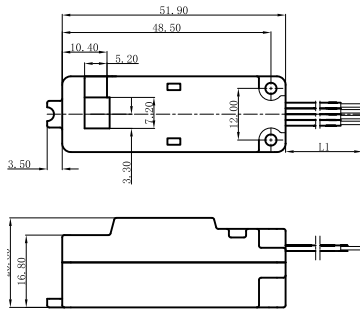

OF	HF	PT	Shaft Strength	OF
700g.cm (Min)	250g.cm (Min)	45°±5°	200N Vertical Axial Force Without Mechanical Damage	250g.cm (Min)

◆ G23A-250AB02A300AAU

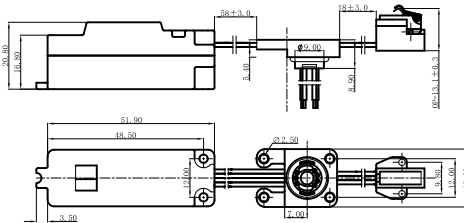
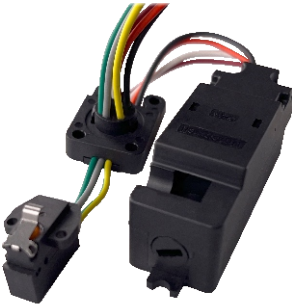

OF	HF	PT	Shaft Strength	OF
700g.cm (Min)	250g.cm (Min)	45°±5°	200N Vertical Axial Force Without Mechanical Damage	250g.cm (Min)

◆ G23A-250AB02A300ABU

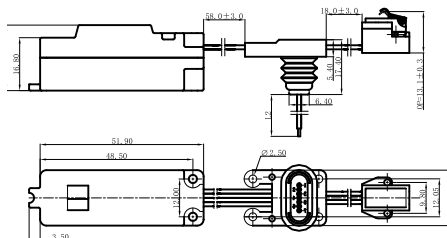

OF	HF	PT	Shaft Strength	OF
700g.cm (Min)	250g.cm (Min)	45°±5°	200N Vertical Axial Force Without Mechanical Damage	250g.cm (Min)